

Eurograb

Compact-Rotator Type 605H-1

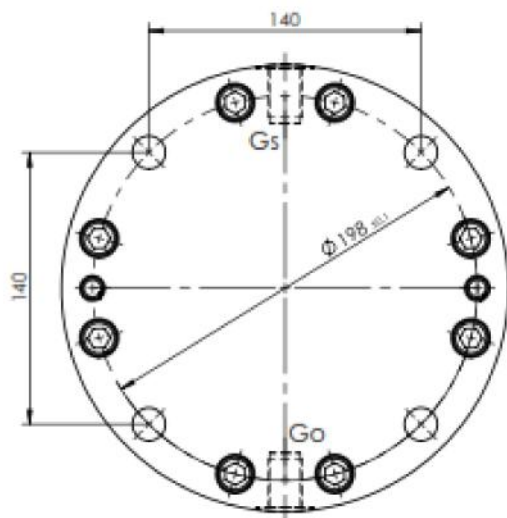

Machine:

e.g. hydraulic excavators-service weight:
max. 10,0 ts with floating attachment
max. 6,0 ts with rigid attachment

Add-on units:

Clamshell buckets of max. 0,6 m³
Grapples of max. 0,25 m³
Grabs for demolition and sorting
of max. 0,3 ts dead load
Special devices on request.

Connex-pin 13x30

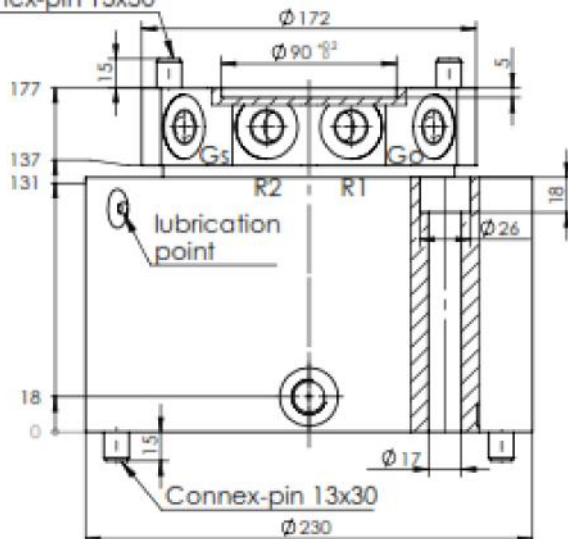

Technical details:

max. thrust load:	= 50 kN
max. radial load:	= 34 kN
p max. grab	= 35 MPa/350bar
p max. rotating engine	= 25 MPa/250bar
max. torque	= 1250 Nm
Torque /100bar	= 500 Nm
Adsorption volume	= 350 cm ³ /R
min. oil passage Gs / Go	= NW 10
Mass	= 40 kg
max. rotations	= 30 rpm
Bending moment Mb per.	= 10 kNm (leaf 4.605.00)

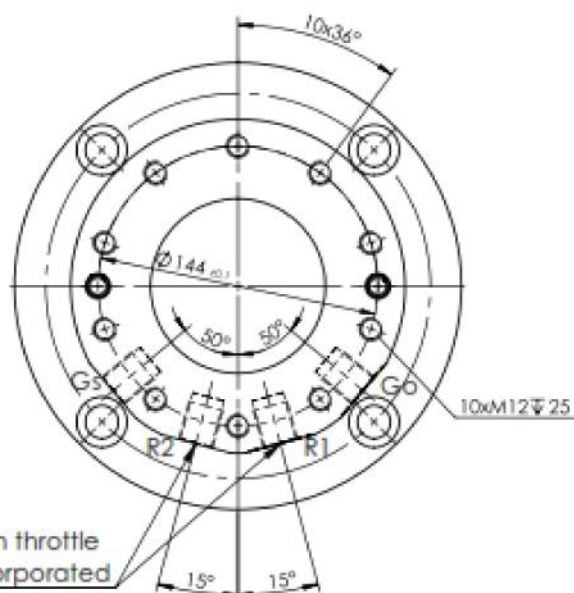

Non-return throttle
valve incorporated

Connections:

R1,R2: rotator rotate
Go: open grab
Gs: close grab

